



S.S.A.A. Rockhampton Branch Inc.

Q07

Cawarral Shooting Complex

PISTOL

Range
Standing
Orders

Do Not Remove

Name	Position	Content Reviewed	Revision Date	Document Version
NAME	POSITION	Initial issue.	16/07/2004	1.0
D. Porteous	President	Emergency contact phone numbers updated	30/06/2015	1.1
Rodney Metcalfe	President	Content Review	14/09/2017	1.2

EMERGENCY PROCEDURES

PHONE:

Ambulance	000	Rockhampton	Ph: 4931 7111
Police	000	Rockhampton	Ph: 4932 3500
Fire	000	Rockhampton	Ph: 4938 4281

FIRST AID KIT LOCATION:

- Located within the metal storage cabinet.

EMERGENCY SERVICES:

Hospital (35km to Rockhampton)
Rockhampton Base Hospital,
Canning St, Rockhampton QLD 4700.
Ph: 4920 6211

Police (35km to Rockhampton)
North Rockhampton Police Station,
Robinson Street, Berserker.QLD 4701.
Ph: 131444

Rural Fire Service (2km to Cawarral)
Cawarral Rural Fire Brigade,
674 Cawarral Road, Cawarral QLD 4702.
Ph: 4935 4000

Area Warden: John McDonald
Tookers Road, Cawarral QLD 4702.
Ph: 4934 4285

All accidents, equipment damage or faults, vandalism and theft are to be notified as soon as possible to a member of the Committee.

COMPLEX LOCATION

Address: 402 Tookers Rd, Cawarral QLD 4702.

Latitude: -23.2193

Longitude: 150.6674

Location of All Ranges:

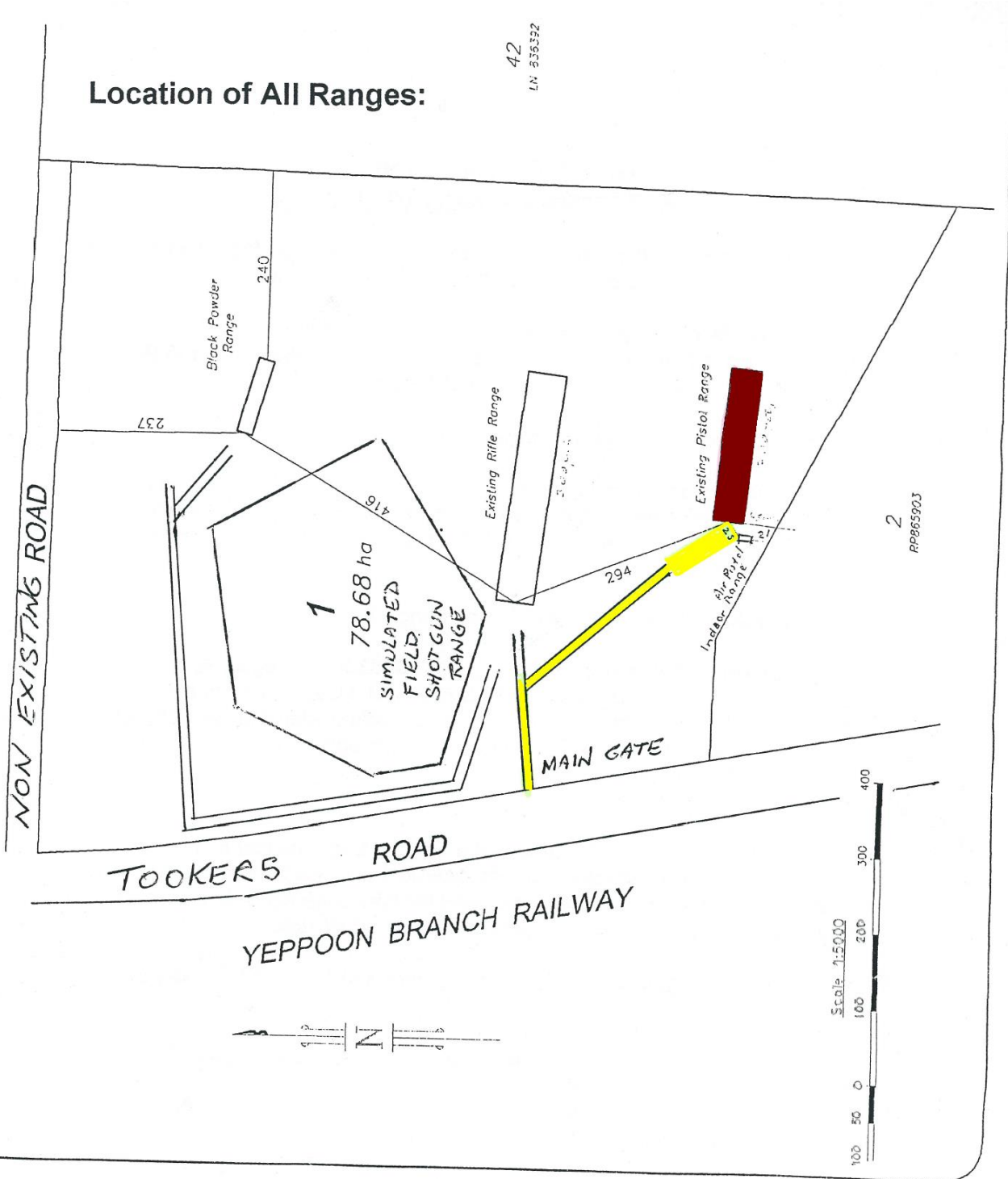

USE OF THE RANGE BY MEMBERS AND VISITORS

All persons attending this range must comply with the Range Standing Orders and the provisions of the Weapons Act 1990 (Qld).

When can the Range be used.

As per the published monthly program of events for SSAA Rockhampton Branch Inc, organised practice or hiring of ranges for private use.

What can be used on the Range.

The use of firearms on this range is limited to those firearm categories, muzzle energies, muzzle velocities, target placement, matches and other conditions as listed on the Police "Approval of a Range" form number 81000083-09 which is displayed on the Pistol Range.

The "Approval of a Range" for the Pistol Range is:

200 metre Pistol Range Approval No. 81000083-09 – Category A (Subject to Committee's discretion), Category B (Subject to Committee's discretion), Category C (Shotgun – Subject to Committee's discretion) and Category H for training and sport target shooting. **RS9** - Muzzle velocity not to exceed 1675 fps (509 mps) for centrefire and Blackpowder. Muzzle velocity not to exceed 1710fps (521 mps) for rimfire. **For all firearms**, muzzle energy not to exceed 1000 foot pound (1356 joules).

All members should read the "Approval of a Range" and note that some categories firearms are **only** permitted for use on the range for training purposes. This means those firearms may only be used for Weapons Act safety courses or training under the supervision of a licensed firearms instructor.

Metallic silhouette targets are only permitted if the targets are defended with baffles.

Ammunition can be factory loads or hand loads and within the permitted muzzle velocities and energies as stated in the "Approval of a Range". The Discipline Captain or Range Operator may inspect hand loads and deny the use of hand loads if considered unsafe for use.

Who can use the Range.

Under provisions of the *Weapons Act 1990* (Qld), a person attending this range to use or physically possess a firearm must:

- Be licensed for the category of the firearm to be used
- Be a visitor who must have photographic Identification, together with a completed **Form 33** and must be supervised by a Range Officer who is licensed for that category of firearm. All **Form 33** shooters must be identifiable while they are in charge of a firearm by wearing a PINK vest at all times.

- **All shooters before discharging a firearm on the ranges must:**
 1. Enter correct details in the Range Register
 2. Produce their license to the Supervising Range Officer or Range Operator
 3. Must not be **subject to a Domestic Violence Order**
 4. Must not be **subject to any Court Action for drugs, weapon or violence offences within the last five (5) years.**

Definition of a Range Officer

For this range, a Range Officer is any licensed adult person who has gained the minimum experience at operating an event on a range and satisfies the requirements of the Range Officers Guidelines, submits the Range Officer application form to the Range Operator and is appointed by the Range Operator.

Temporary Range Officer.

For these ranges, a Temporary Range Officer may be appointed by the Discipline Captain to help and mentor Form 33 shooters. This temporary position will exist only for the duration of the shoot and the appointed person must sign the Temporary Range Officer Register. By signing this register the Temporary Range Officer agrees to the conditions that are set out in the Branch Range Officers Guidelines.

Conditions for use of the Range by Licenced Juniors (Minors).

For persons under the age of eighteen (18), the following applies (Weapons Act 1990 (Qld) s53):

- For their first three (3) visits, the minor must be supervised directly. eg. one on one with a Range Officer or Temporary Range Officer.
- After three (3) visits, the minor may be supervised by a Range Officer, providing the Range Officer does not supervise more than six (6) minors.

Special Consideration.

This is a "Limited Danger Area Range" with Hill Height Dispensation. This means that the range relies on the construction of mounds, walls and baffles to stop projectiles departing the Range. It is essential that an extremely high standard of shooter discipline be maintained. Shooters must take all possible care to eliminate errant shots, including high shots and ricochets. Evidence of projectiles leaving the Range will result in closure of the complex.

GENERAL PROCEDURES

For programmed events, practice or complex hire:

1. The red flags are to be put up prior to commencement of firing being conducted on the range. Red flags are not to be flown when there is no shooting on the range. During night shoots red flags are to be clearly illuminated or replaced by red lights. For use of the Pistol Range, the red flags to be displayed are the front gate flag, the caution diamonds on the range directory and the Pistol Range flag located at the rear of the firing line. All flags are kept at the base of each flagpole in a PVC container.
2. **All shooters, spectators or visitors are to comply with all instructions from the Discipline Captain or Range Officer** and follow the Range Standing Orders, match and interim club rules. Failure to comply, without reasonable excuse, is an offence under the *Weapons Act 1990* (Qld). Dissent with the Range Officer will result in you being asked to leave the range immediately.
3. All Range Officers are to display the name of the event, the date, their licence number and their name and the names of the Temporary Range Officers and their licence numbers on the notice board which is located on the shed wall behind sign in counter. Discipline Captains and Range Officers must adhere to these Range Standing Orders, and the relevant match rules as stipulated by SSAA Event Rules and club rules.
4. **No shooter under the influence of alcohol or drugs will discharge a firearm on the range.**
5. Smoking on ALL ranges is prohibited.
6. **All persons before discharging a firearm at the Pistol Range must fill in the Range Register (Form 20)** which is located in the drawer under sign in counter. Shooters are to produce their Weapons Licence, State Membership card and current Amenity card to the Discipline Captain or Range Operator. Unlicensed persons must fill out a Form 33 and provide photo ID to the Discipline Captain or Range Operator. All Form 33 shooters are to be identifiable by wearing a PINK vest while they are in charge of a firearm. Every entry in the Range Register is to be signed off by the Discipline Captain or Range Operator as required under the Weapons Act. VISITORS not discharging a firearm or attending the ranges for other reasons (such as a working bee) are requested to fill out the Visitors Register.
7. All firearms used on the range must be in good working order and should be carried from the car park in a cover, bag, box or case and at all times be pointed in a safe direction and unloaded.
8. Only one pistol may be carried per cover, bag, box or case. A shooter wearing a holstered pistol may not simultaneously use a second pistol from a case.
9. All shooting must be at targets “down the range”. Overriding all match rules – no loaded pistol or rifle shall have its muzzle pointed above the top of the hill, nor to the left or right outside the target area.
10. All shooting or training is to be under the supervision of a Range Officer or Temporary Range Officer and their name recorded on the notice board situated on the shed wall behind sign in counter. Practicing alone is not permitted.

11. No new shooter may shoot without direct one-to-one supervision until deemed proficient by the Range Officer or Temporary Range Officer. All new Form 33 shooters are to wear a PINK vest while they are in charge of a firearm.
12. All persons whilst on or near the firing lines MUST wear hearing and eye protection.
13. Shooters are to wear suitable clothing and covered footwear to prevent injury from hot ejected cases.
14. No person may use a holster until having successfully completed a recognised Holster Proficiency Test and be participating in an Action event. Holstered firearms are not to be worn in any other place other than under the covered area of the range (A shooter is to remove his holstered firearm when going to and from the toilet area and car park).
15. The handling of firearms is not permitted while the Range is closed, while persons are forward of the firing line, or by a person who is intoxicated, consuming alcohol, stupefying drugs or displays argumentative actions.
16. **Firearms will not be loaded until instructed by the Range Officer and every shooter will ensure the muzzle is pointed down range or in a safe direction at all times.**
17. If a firearm develops a fault it must be kept pointed down range with the finger outside the trigger guard and the Range Officer called.
18. No shooter will handle another shooter's firearm or ammunition without their permission, except when a Range Officer believes a firearm is pointed in a dangerous direction and either acts or gives instruction to another to reposition the firearm in a safe position or direction.
19. No shooter will leave a loaded firearm unattended or in an uncontrolled state. If a shooter must put a firearm down for any reason, it must be unloaded first.
20. Only the detail shooting is allowed at the firing line and all other people must remain well behind the firing line, except when a Range Officer is required to supervise a new shooter. All shooters in the detail must remain at the firing line until released by the Range Officer.
21. When the Range Officer gives the command to Cease Fire, or any person gives the command to "Stop Stop Stop", all shooting must cease immediately.
22. When the Range Officer gives the command to Unload and Show Clear, all shooters will empty the chambers of their firearms, drop magazines if possible or open actions as applicable. The Range Officer will then inspect each firearm to ensure they are clear and unloaded.
23. No shooter is to leave the firing line before their firearm has been cleared by the Range Officer. Once the range is closed no shooter may enter over the yellow safety line unless authorised by the Discipline Captain or Range Officer in charge of the Range.
24. Unloaded firearms must be placed on the bench, gun rack, case or carry bag, or holstered and not touched until the order to reload is given.
25. During a cease fire, any loaded magazines must be pocketed or holstered.
26. Firearms may be taken to the "Safe Area" for cleaning, repairs or commissioning, if such an area is provided. No ammunition is to be taken to the "Safe Area".

27. The only targets to be used on this range are to be made of paper, cardboard, soft product (such as balloons) or be approved splatter guarded metallic silhouettes and IPSC poppers. The shooting of cans, bottles, bricks, blocks, steel, wood, 44 gallon drums or other items that may produce ricochets or rubbish is prohibited. The deliberate shooting of signs, target numbers or frames, walls, damage or destruction of club property is illegal under s110 of the *Weapons Act 1990* (Qld).
28. All targets are to be placed in a manner so that when they are shot at, the bullet enters the stop butt or bullet traps. For example, in IPSC matches do not have firing points on the left side of the range that have to shoot at a target on the right hand side of the range. Targets are to be set so that all shooting is conducted straight down the length of the range.
29. Resetting of silhouettes and scoring and patching of targets during range closure must be done quickly so as to not inconvenience shooters.
30. Spent cases are to be picked up and removed from the firing line.
31. Rapid fire is not permitted on the range during practice sessions unless authorised and justified by the Range Officer.
32. All safety breaches are to be brought to the attention of the Discipline Captain or Range Operator or be made in writing to the Range Operator.
33. Visitors must be closely supervised and minors are to be under the control of a designated Range Officer.
34. No person under the age of eleven (11) will be allowed to handle any firearm nor will they be allowed near the firing line.
35. Any infringement of these rules whether it is intentional or not, may result in disciplinary action which could result in disqualification from the range for the duration of the match or event.
36. At the conclusion of shooting, the red flags, Range Register and Visitors Book are to be put away and you are requested to put away mats, timers, targets, target frames, patches etc... and leave the Range in a clean and tidy condition. The last to leave the complex is to secure all locks on the sheds, containers and front gate etc...